

## SAFETY & WARNINGS

1. Install in accordance with national and local electrical code regulations.
2. This product is intended to be installed and serviced by a qualified, licensed electrician.
3. Do not modify or disassemble this product beyond instructions or the warranty will be void.
4. Do not submerge, or install within 5 feet of a swimming pool.
5. Only install with a Listed Class 2 DC LED driver.
6. To avoid Voltage Drop, ensure wire gauge used with LED Strip Light is sufficient to keep under 3% voltage drop.
7. DO NOT connect directly to high voltage power.
8. Only install compatible 12V and 24VDC constant voltage luminaires.
9. This product is rated for indoor installation and is not protected against moisture.
10. Failure to follow safety warnings, and installation instructions will void the warranty for this product.



## QUICK SPECS / MODELS

SKU	DI-SWTH-PSV
Input	12 - 24VDC Constant Voltage
Output	12 - 24VDC Constant Voltage
Max Load	12V 60W (5A), 24V 96W (4A)
Ambient Temp †	-4° - 122°F (-20° - 50°C)

† Do not install product in environment outside listed temperature.

## REQUIRED COMPONENTS

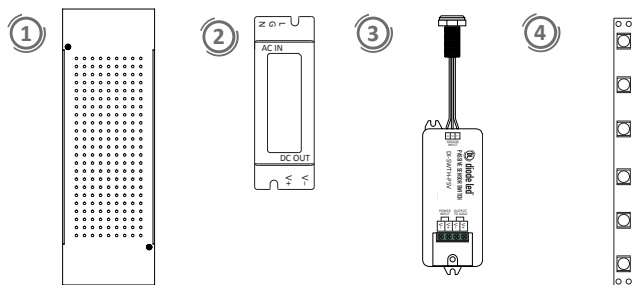

1. Appropriate Junction Box
2. Class 2 rated Driver
3. PASSIVE SENSOR SWITCH
4. LED Tape Light

## REQUIRED TOOLS

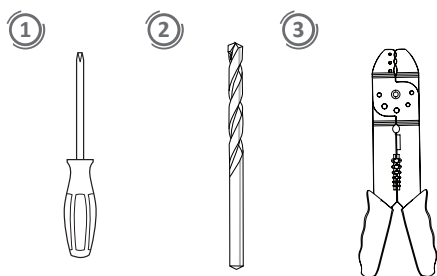

1. Phillips-head Screwdriver
2. 7/16 inch Drill Bit
3. Wire Stripper

## INSTALLATION

### 1 TURN POWER OFF AT CIRCUIT BREAKER



**SHOCK HAZARD! May result in serious injury or death.**

Turn power OFF at circuit breaker prior to installation.

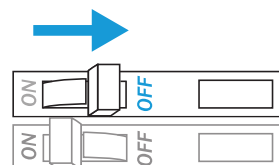

### 2 DETERMINE LOCATION TO INSTALL COMPONENTS

**\*NOT FOR USE IN SUBMERSIBLE APPLICATIONS, OR WITHIN 5 FEET OF A SWIMMING POOL.**

Refer to **SYSTEM DIAGRAMS**

#### WIRE GAUGE & VOLTAGE DROP

Ensure appropriate wire is installed between driver, fixture, and any controls in between. When choosing wire, factor in voltage drop, amperage rating, and type (in-wall rated, wet location rated, etc.)

For more information, refer to system diagrams and voltage drop charts at the end of this document.

# PASSIVE SENSOR SWITCH

## INSTALLATION GUIDE

### INSTALLATION (CONT.)

#### 3 PASSIVE SENSOR PLACEMENT

- Using a 7/16 inch Drill Bit, create a hole where you would like to place the Sensor.
- Loosen Nut from the Passive Sensor.
- Insert Passive Sensor into 7/16 inch hole.
- Tighten Nut onto back of Passive Sensor.

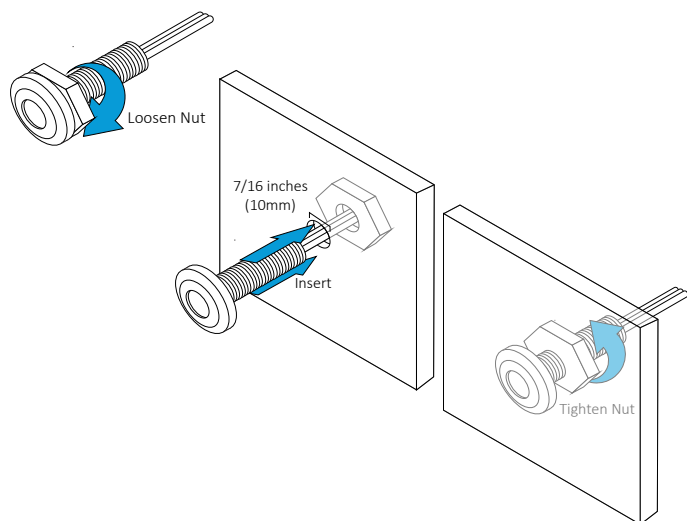

#### 4 CONNECT PASSIVE SENSOR TO SWITCH

Ensure the Connector is facing correctly when inserted into Switch.(shown below)

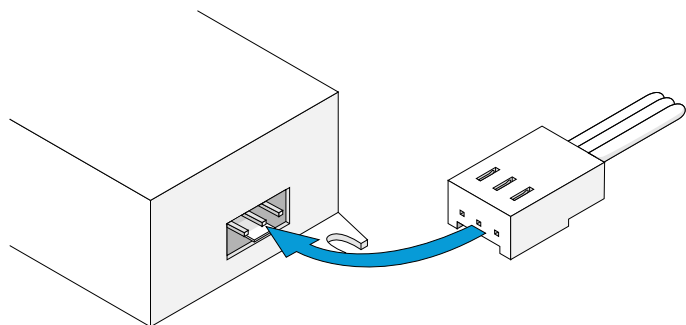

#### 5 WIRE DRIVER & LUMINAIRE TO SENSOR SWITCH

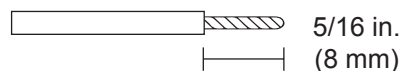

- Strip wires.

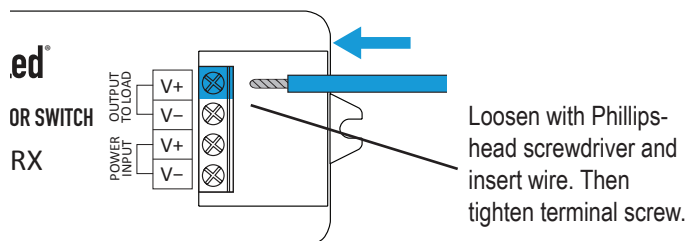

- Wire Class 2 driver and LED luminaire to Sensor Switch. See **SYSTEM DIAGRAM**.

#### 6 TURN POWER ON AT CIRCUIT BREAKER

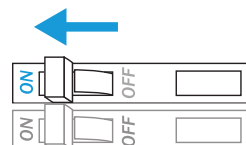

# PASSIVE SENSOR SWITCH

## INSTALLATION GUIDE

### SYSTEM DIAGRAM

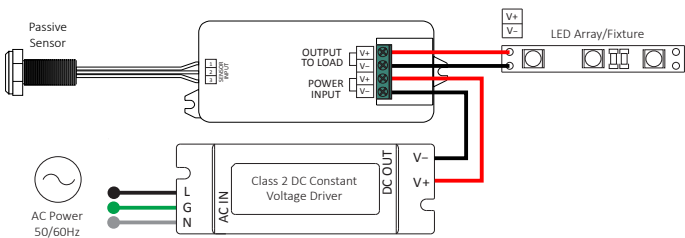

### OPERATION

<b>On/Off</b>	Whenever an object passes completely through the sensor range.
<b>Sensor Range</b>	< 2.3 inches
<b>Sensory Angle</b>	60°
<b>Diameter for Drilling</b>	7/16 inch Drill Bit. (10mm)

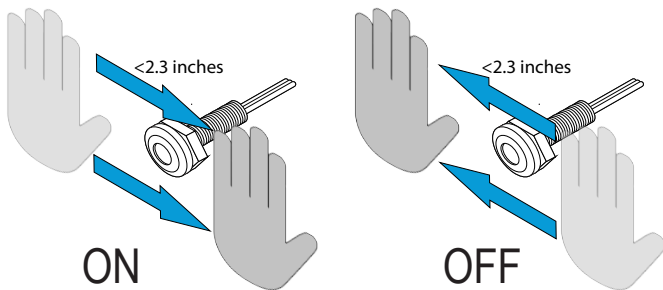

### TROUBLESHOOTING

Prior to troubleshooting, turn power OFF at circuit breaker and verify all connections.

Symptom	Common Cause
Luminaire does not illuminate	<ul style="list-style-type: none"><li>Incorrect wiring.</li><li>Polarity of Low Voltage V+ and V- are reversed.</li><li>Circuit breaker is OFF or tripped.</li><li>Incorrect voltage pairing of dimmer and luminaire. 12V drivers models will not power a luminaire with a higher voltage rating.</li><li>Connecting the Sensor Switch to a second Controller may result in a delayed response time.</li></ul>
Luminaire heats up excessively	<ul style="list-style-type: none"><li>Incorrect voltage pairing of driver and luminaire. Do not attach a 12V luminaire to a 24V driver.</li><li>Luminaire is not compatible.</li><li>Refer to luminaire install guide warnings and safety tips.</li></ul>

### ADDITIONAL RESOURCES

#### PASSIVE SENSOR SWITCH SPEC SHEET

For full specifications.

#### CONSTANT VOLTAGE DRIVER SPEC SHEET & INSTALL GUIDE

For full specifications and installation instructions.

#### LED TAPE LIGHT SHEET & INSTALL GUIDE

For full specifications and installation instructions.



Toll Free: 877.817.6028 | Fax: 415.592.1596 | [www.DiodeLED.com](http://www.DiodeLED.com) | [info@DiodeLED.com](mailto:info@DiodeLED.com)  
© 2015 Elemental LED Inc. All rights reserved. Specifications are subject to change without notice.